

SCGB-1A KT GROUND BAR KIT

- 1 PC - SCGB-1 BUSBAR
- 2 PCS - SCBKT-1A BRACKET
- 2 PCS - 1603-2A or R2137-A4 INSULATOR
- 4 PCS - 3/8-16 x .75" BOLT
- 4 PCS - 3/8" LOCKWASHER

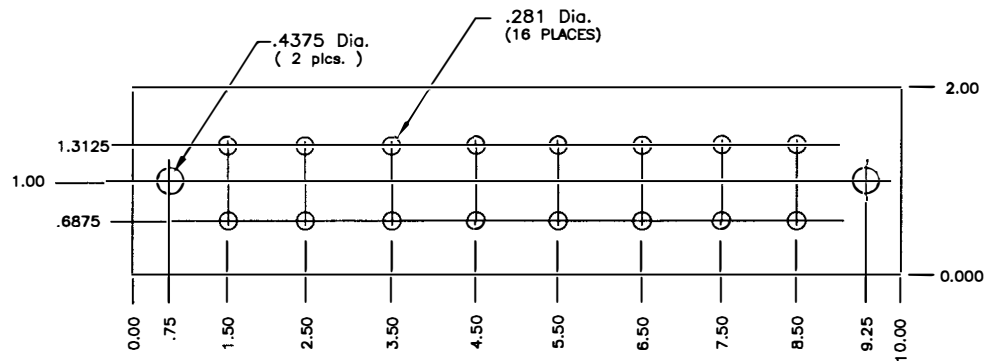

SCGB-1KT Includes:

- 2 - 2015-3C Insulators
- 2 - SCBKT-1 Brackets
- 4 - 3/8" X 1" Steel w/Zinc plating Bolts
- 4 - 3/8" Steel w/Zinc plating Lockwashers



MATERIAL	UNLESS OTHERWISE SPECIFIED DIMENSIONS ARE IN INCHES TOLERANCES ON
1/4" X 2" E.G. COPPER	FRACTIONS DECIMALS ANGLES MIN. BEND RAD. ±1/32" ±0.031 ±1.5° (1)T
FINISH:	DO NOT SCALE DRAWING
Bare	SCGB-1
SHEET 1 OF 1	COMPUTER GENERATED DRAWING

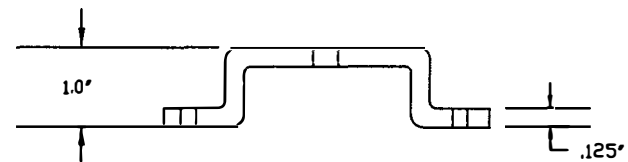
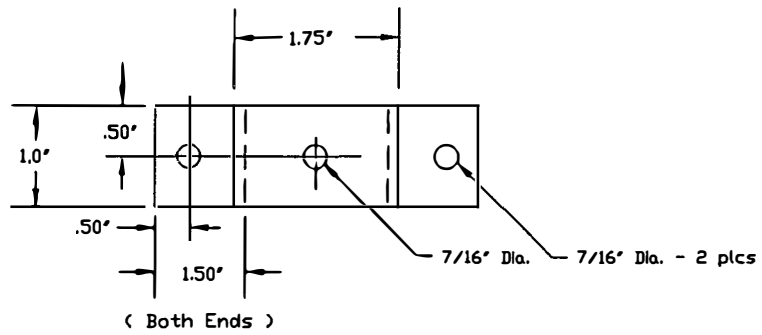

## STORM POWER COMPONENTS

DESCRIPTION: .125" X 1.0" 304 Stainless Steel Bar		SCALE: UNLESS OTHERWISE SPECIFIED TOLERANCES IN ANGLES ± 1° DECIMALS .X ± .030°	
CREATED BY: BPZ	DATE: 4/01/05	FIRST USED ON UM:	MOLE DIAMETERS ± .005°
Finish: Bare	CATEGORY:	REVISION: RH/CN/SPRN NO.	DATE APPR. APPROVED BY:
RESPONSIBLE ENGINEER:	SECURITY CLASS:	OBJECT ID: SCBKT-1A	Rev: 0
LAST MODIFIED BY:	DATE:	VERSION: B	SIZE: B

△ THESE DRAWINGS AND SPECIFICATIONS ARE THE PROPERTY OF STORM COPPER AND SHALL NOT BE REPRODUCED OR COPIED OR USED AS THE BASIS FOR MANUFACTURE OR SALE WITHOUT PERMISSION